

## HIGH PRECISION THIN SHUTTER

- \*HIGH PRECISION TRAVEL
- \*BAKEABLE TO 300°C
- \*THIN AND SPACE SAVING
- \*MOUNTING IN ANY POSITION
- \*COST SAVING

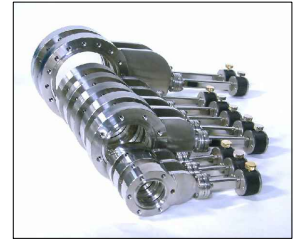

Inside the vacuum system movable shields are suitable to protect viewports, vary the conductance of a pumping line, insert optical filters, to shut down particle beams.

To overcome this problem we offer a series of shutters designed as a double face flange with threaded holes. The chosen materials are suitable for UHV and are bakeable up to 300°C without dismantling the magnets. Sliding motion is driven by rotary magnetic manipulator with strong magnetic couple so the shutter can be mounted in any attitude.

The main advantage is that you can install these shutters below the window you have on your UHV chamber, without any modification.

In flag and venetian blind shutters, some parts remain in the field of view all of the time : in our case, when opened, the viewport section is totally free.

The thin shutters are manually operated and can be stopped in any position of the travel with a lock screw.

On request special models are available with step motor. The shutter terminal is dismountable, so different materials are insertable as molybdenum, tungsten, inconel or optical filter settled into the shutter.

Exploiting the use of CF16 magnetic rotating driver has eliminated the introduction of bellows in the motion system, so you have lower cost and longer life.

### SPECIFICATIONS

	Mod TS16	Mod TS40
Flange	CF16 double face tapped holes M4	CF40 double face tapped holes M6
Stroke	18 mm	41 mm
Precision	<0.01 mm	<0.01 mm
Vacuum	2.10 <sup>-11</sup> mbar	2.10 <sup>-11</sup> mbar
Bake out	300 °C	300 °C
Code	TM 025	TM 026

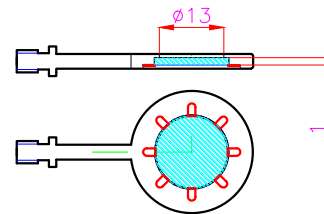

Shutter with inserted diamond window

